

PosMaster PCI Profibus DP Card

품 명 : PosMaster PCI Profibus DP 1Port Card

품목 Code : PMPLC-PCI-PD1PHS-100

일반 사양 :

PC Card cifX PCI 2 channel PROFIBUS DP Master
RAM : 8MB SDRAM
FLASH : 4 MB serial Flash EPROM

Profibus DP 1Port Card Data

Model number	PMPLC-PCI-PD1PHS-100
General information	
Part	
Description	PC Card cifX PCI 2 channel PROFIBUS DP Master
Function	Communication interface with PCI and 2 x PROFIBUS interface
Communication Controller	netX 100 processor
Integrated Memory	
RAM	8 MB SDRAM
FLASH	4 MB serial Flash EPROM
Size of the Dual-Port Memory	64 KByte
System Interface	
Bus Type	PCI, according to [bus spec 1]
Transmission Rate	33 MHz
Data Access	DPM or DMA (Direct Memory Access)
Width for the data access to the Dual-Port Memory (DPM)	32-Bit
PROFIBUS Communication	PROFIBUS DP Master,
PROFIBUS Interface	
Transmission rate	9,6 kBit/s, 19,2 kBit/s, 31,25 kBit/s, 45,45 kBit/s, 93,75 kBit/s, 187,5 kBit/s, 500 kBit/s, 1,5 MBit/s, 3 MBit/s, 6 MBit/s, 12 MBit/s
Interface Type	2 * RS 485, refer to section <i>PROFIBUS Interface</i> p. 107
Galvanic Isolation	isolated
Isolation Voltage	1000 VDC (tested for 1 minute)
Connector	DSub female Connector, 9 pin
Display	SYS System Status LED COM 0 LED Communication Status 0 (duo LED) for channel X1 COM 1 LED Communication Status 1 (duo LED) for channel X2 Display LED Display The meaning of the LEDs COM0 and COM1 depends

	on the loaded firmware. Refer to ch. <i>LED Descriptions</i> , p. 80.
Power supply	
Supply Voltage	+3.3 V dc $\pm 5\%$, refer to section <i>Power Supply and Host</i> .
Maximum Current at 3.3 V (typically)	700 mA
Connector	Via PCI Bus
Operation	
Rotary Switch Slot Number (Card ID)	To set the Slot Number (Card ID)
Environmental Conditions	
Operating temperature range*	-20 °C ... +70 °C (<i>acc. to UL: 0 °C ... +55 °C</i>)
Air flow during measurement	0,5m/s
Storage temperature range	-10 °C ... +70 °C
Humidity	10 ... 95% relative humidity, no condensation permitted
Environment	For UL compliant usage: The device must be used in a pollution degree 2 environment.
Dimensions (L x W x H)	120 x 86 x 18,5 mm

DIMENSION :

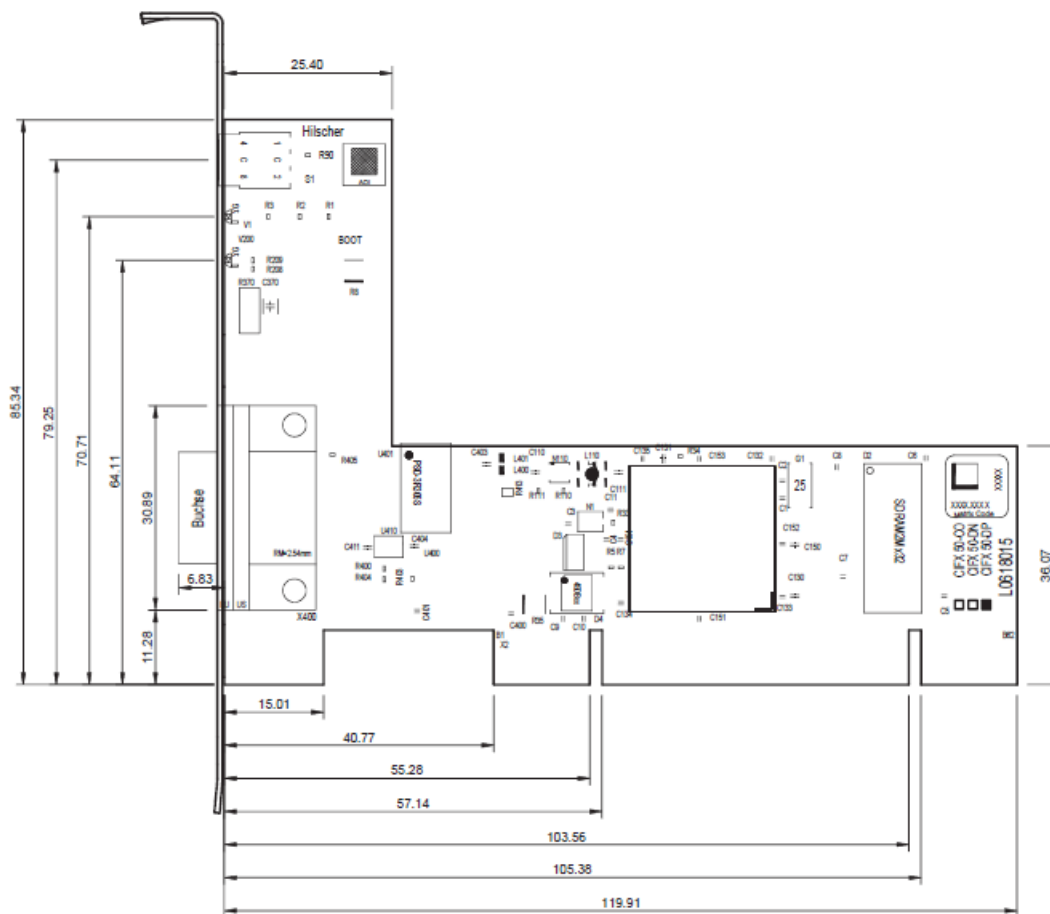



https://www.poscoict.com/business/smart_solution06.jsp